

INTRODUCING **MODULE-AIR®** INNOVATIVE OEM TRAILER SOLUTION

BENEFITS

UNMATCHED CONFIGURABILITY

Get exactly what you need for your specific trailer configuration.

SIMPLE INSTALLATION

Combined valve design & centralized connection points reduce leak paths and **makes installation a breeze.**

RUGGED CONSTRUCTION

Impact resistant composite box with stainless steel latch protects the longest lasting valves on the market.



HOW IT WORKS: Module-AIR® is our new innovative control system designed to give customers maximum configurability and ease of installation. Install time is cut significantly by centralizing all controls inside an impenetrable box, **saving trailer assembly time and money.**



WHY IT WORKS: We have taken our DOT valves that have been specifically designed for the trailer market and integrated them into a manifold system, reducing connection points and leak paths. You get a highly reliable system that will **improve your brand reputation.**

WHY CHOOSE ALKON

- **U.S. MANUFACTURED: No port, no problems;** Our product is manufactured at our plants in Michigan and Ohio, protecting you from the next supply chain crisis.
- **AIRTIGHT QUALITY:** Our compact product package with reduced leak paths has been extensively tested, ensuring your customers will be delighted with the durability of the product.
- **RESPONSIVE:** Talk to a live person via phone or email for all purchase orders, questions or concerns.
- **ALWAYS INNOVATING:** Alkon provides aftermarket and OEM solutions specifically designed for the tractor and trailer market.

GAIN YOUR COMPETITIVE EDGE NOW!

Module-AIR® will help trailer OEMs improve their reputation. Call today to see how you can gain a competitive advantage!

THE ALKON FAMILY
OF COMPANIES



DIMENSIONAL INFORMATION

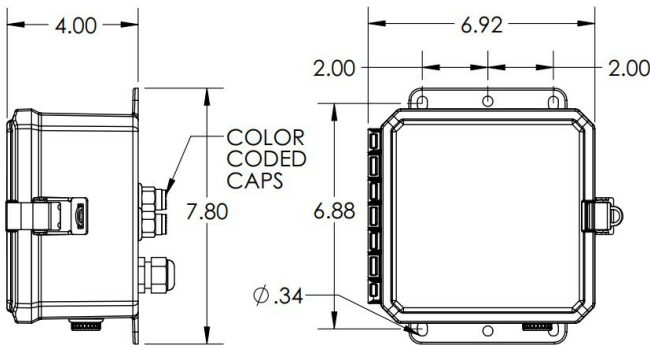

SINGLE VALVE BOX DIMENSIONS

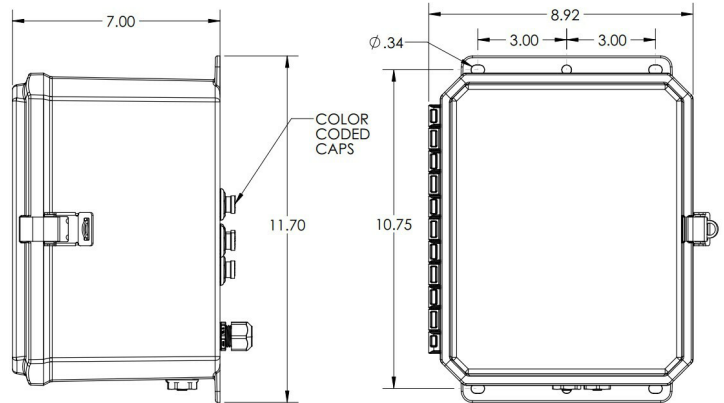

MULTI-VALVE BOX DIMENSION

DESIGN SPECIFICATIONS

Operating Temperature	-40 to +180°F
Operating Pressures*	0 to 150 PSI
DOT Fitting Size	3/8" Tube
Gauge Range	0 to 160 PSI

*Minimum of 60 PSI tank pressure required

CAP COLOR	TO / FROM	CAP COLOR	TO / FROM
Red	Supply / Tank	Yellow	Tailgate Cylinder
Green	HCV / Suspension	Black	Air Cab Control
Violet	Ride Bags, Equalized	Orange	Slider / Dolly Lock
Gray	Lift Bags	Blue	Brake Release

PART NUMBER INFORMATION

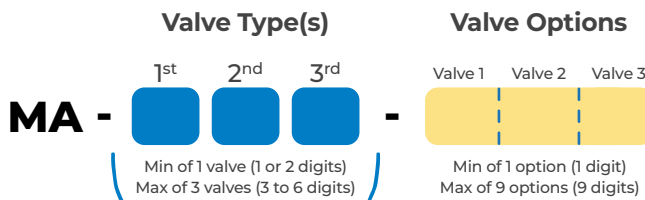

VALVE TYPE(S)

VALVE CODE	VALVE	OPTIONS	NOTES
D	Dump	1 from: #1	1st valve station only
L	Lift	1 from each: #1, #2 & #3	
T	Tailgate Lock	1 from: #1	
R	Slider Lock	1 from: #1	
K	Dolly Lock	1 from: #1	
TO	Tailgate Open	1 from each: #1 & #4	
BR	Brake Release	1 from each: #1 & #4	

OPTION #1 - VALVE CONTROL OPTIONS

OPTION CODE	CONTROL TYPE	NOTES
P	Manual Push/Pull	Z only for Option #3
S	Solenoid w/ manual override	
A	Air w/ manual override	
H	Auto	Dump valve only

OPTION #2 - SUSPENSION TYPE

OPTION CODE	SUSPENSION
E	Equalized
R	Regulated

OPTION #3 - LIFT AXLE POSITION

OPTION CODE	POSITION	ENERGIZED STATE
U	Normally Up	Signal to Lower
D	Normally Down	Signal to Lift
Z	Choose for P Option	

OPTION #4 - VALVE FORMAT

OPTION CODE	FORMAT
NO	Normally Open
NC	Normally Closed

Part Number Example: MA-DLT-PSEUS; Valve #1 is D for Dump Valve and P for Manual Push/Pull; Valve #2 is L for Lift Valve, S for Solenoid controlled, E for Equalized Suspension and U for Axle Normally Up; Valve #3 is T for Tailgate Lock and S for Solenoid control.